

# ALTA

MATERIAL HANDLING

## Warehouse Solutions



# Achieve Success with an Integrated Solution

Customer demands and operational challenges related to warehousing are on the rise and are more pronounced than ever. At Alta Material Handling, our goal is to help you meet these demands proactively and stay ahead of industry trends. By thoroughly analyzing your operations, we create customized solutions for process optimization, enhanced efficiency, and productivity.

[Integration & Engineering](#)

[Reach Truck](#)

[Electric Lift Trucks](#)

[Electric Pallet Trucks](#)

[Electric Ride-On Pallet Trucks](#)

[Order Pickers](#)

[Case Pickers](#)

[Very Narrow Aisle](#)

[Narrow Aisle](#)

[Lift Truck Attachments](#)

[Operator Assist System](#)

[Telemetry](#)

[Motive Power](#)

[Racking Solutions](#)

[Training](#)

[Service & Support](#)



# LES is More

Achieve increased and sustainable productivity, throughput, and profitability using our LES is More philosophy – less Labor, Energy, and Space. Alta Material Handling helps save your facility labor, energy, and space through custom warehouse design, solutions, and equipment.

## Labor

Our automated solutions touch nearly every aspect of supply chain operations, product transport, sorting, picking, distribution, and even cleaning to improve all facets of your labor usage.



## Energy

Our primary goal is to provide our customers with the safest and most efficient energy solutions on the market, while meeting your budgetary and operational needs.



## Space

Our space solutions will help you optimize every square inch of your building, with customizable, tailor-made vertical and horizontal solutions.

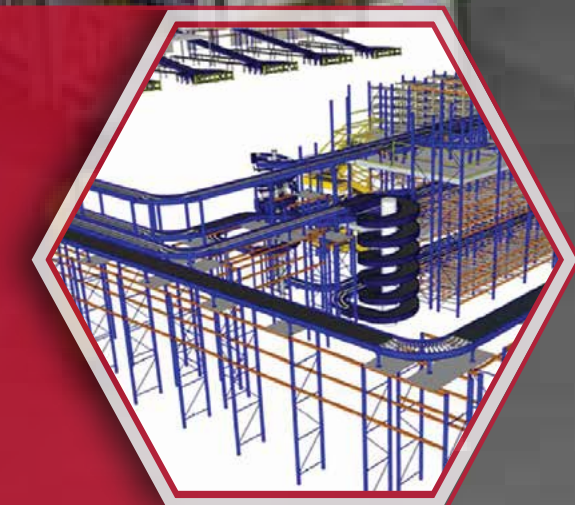

## A Integration & Engineering



# PEAKLOGIX

AN ALTA MATERIAL HANDLING COMPANY

# Optimize & Manage Your Warehouse More Efficiently

Through intelligent warehouse design and tailored integrations, PeakLogix has been improving warehouse efficiency for over thirty years. They are experts at lowering costs while increasing throughput, improving productivity, and gaining efficiencies. Our team will collaborate closely with yours to create custom solutions that support your priorities and goals and improve your material handling and order fulfillment processes.

## Equipment Solutions for Warehouse Automation



↗ **Traditional Installations**  
Providing storage and engineered product solutions



↗ **Advanced Integrations**  
Delivering customized solutions for operational success

## In-House Technology Services

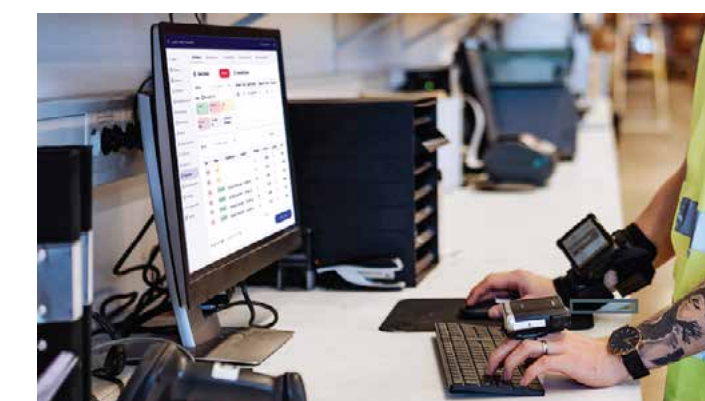

↗ **ScottTech PickPro**  
An advanced warehouse management software solution



↗ **Controls**  
In-house tailored controls with remote support and service

## **A** Reach Truck

# Boost productivity with just one additional pallet move per hour



With a 3,000-4,500-lb capacity range and single or deep reach capabilities, Yale® narrow aisle [reach trucks](#) combine the latest technology with next-level performance to help exceed expectations in high-density warehousing.



VISIBILITY



FASTER CYCLE TIMES



ENERGY EFFICIENCY



ERGONOMICS



SERVICEABILITY



[LEARN MORE](#)

## **A** Electric Lift Trucks

Yale® 3-wheel and 4-wheel electric forklifts are versatile pieces of material handling equipment used for lifting and stacking loads in a variety of indoor and outdoor applications across a wide range of industries and can be equipped with different attachments for unique handling requirements.



**Four-wheel sit-down  
electric counterbalance  
3,000-12,000lbs**



**Three & four-wheel  
sit-down electric counterbalance  
Indoor/Outdoor  
3,000-7,000lbs**



## A Electric Lift Trucks



# Three-wheel stand-up electric counterbalanced



The [three-wheel](#) stand-up forklift can help you move products in and out of tight spaces more efficiently and enhance operator productivity in the following applications: Dock-to-stock load transportation, loading and unloading, staging, and stock replenishment.



**MODELS**  
ESC030-40AD  
**CAPACITY**  
3000-4000lbs



[LEARN MORE](#)

## A Electric Lift Trucks



# Three & four-wheel electric counterbalance fully integrated lithium-ion 4,000-6,000lbs

- Fully charge in as little as 1-2 hours
- Deliver consistent power until full depletion
- Reach up to 8 hours of continuous runtime
- Lithium ion requires less maintenance. No watering is required, no washing, and no equalization charges

LI-ION



**Yale** 

[LEARN MORE](#)



## A Electric Pallet Trucks

# Move loads quickly and efficiently



**Yale** 

### MPS30UX

- Capacity - 3,300 lbs.
- Power Supply - 48 Volt 15 AH, Lithium Ion
- Charger - Portable 110 AC
- Fork Dimensions - 27" X 48"

[LEARN MORE](#) 



### MPB045VH Lead Acid

- Capacity - 4,500 lbs.
- Power Supply - 24 volt 158 AH, 4) Separate Lead Acid Deep Cycle
- Charger - Built in 110 VAC
- Fork Dimensions - 27" X 46"

*\*Image is shown with an optional Load backrest*



### MPB045VH Lithium Ion

- Capacity - 4,500 lbs.
- Power Supply - 24 volt 100 AH, Lithium Ion
- Charger - Built in 110 VAC
- Fork Dimensions - 27" X 46"

*\*Image is shown with an optional Load backrest*



## **A** Electric Ride-On Pallet Trucks



# Boost order picking, escalate throughput

### End Rider Pallet Truck

- 6K and 8K configurations
- Multiple pick-assist features to enhance productivity
- Exclusive platform safety light and forward-facing LEDs for operator visibility
- Available extended operator platform

[LEARN MORE](#)

### Enclosed End Rider

- Electronic power steering
- Four-point chassis design
- Exclusive 10k capacity, available in 192 fork length
- Exclusive pedal-free operator sensing system

[LEARN MORE](#)

### Center Rider Pallet Jack

- Speeds up to 8 mph helps reduce travel time
- Platform height does not change when forks are raised to maintain a consistent safe entry and exit
- Available in single, double, and triple configurations
- Four-point chassis design

[LEARN MORE](#)

## A Order Pickers

# Take order picking to the next level

**Yale** 

### Medium & high lift order picker

- The Smart-Glide™ height and load sensing system optimizes travel speeds and acceleration
- The multifunction control handle simultaneously controls several functions
- Standard AC technology with CANbus communication provides efficient operation with fewer parts

[LEARN MORE](#) 

### Low-level order picker

- Optional lifting operator platform for second level picking
- Operators can easily access the 6 to 10-foot strike zone without stretching and straining enabling high-density slotting strategies
- Available in single, double, and triple configurations
- Speeds up to 8 mph help limit travel time

[LEARN MORE](#) 

## A Very Narrow Aisle



## ACCESS THE HIGHEST STORAGE LOCATIONS IN TIGHT AISLES

The [Yale® NTASB](#) very narrow aisle (VNA) turret truck helps warehouses increase storage capacity by up to 50% compared to conventional storage systems by working in aisles as narrow as 56 inches and racking up to 622 inches.



### Productivity

The Smart-Glide™ height and load sensing optimizes travel speeds and acceleration.



### Ergonomics

Adjustable arm rests, low effort rotary grips, and optional forward mounted controls keep operators comfortable.



### Dependability

Wireless system to control truck speeds and mast heights, identify aisles and limit truck functions.



### Cost of Operation

Standard AC technology with CANbus communication provides more efficient operation with fewer parts.



[LEARN MORE](#)

## A Case Pickers



### Sidewinder

- Up to 880 lbs. capacity
- Up to 165" lift height
- Internal smart charger
- Exceptional stability

[LEARN MORE](#)

**TASK**  
FORKLIFTS USA INC

## BLUE GIANT®



### BG ZERO

- Powered front load tray
- Electronic power steering
- Forward facing blue light
- Rear flashing warning light
- Battery discharge indicator w/hour meter



### BG1

- Electronic power steering
- Large operator compartment with cushioned floor and backrest
- Hide away work tray
- Front and rear flashing lights
- Audible alarm when guardrail is raised

[LEARN MORE](#)

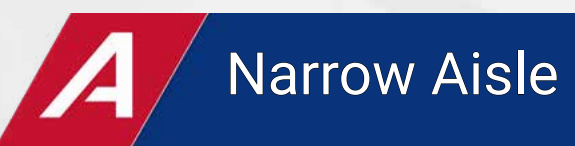

# AiSLE MASTER

LIFTING INNOVATION

Save money and increase storage space with [Aisle Master](#). The Very Narrow Aisle articulated forklift helps you maximize your storage capacity. Its ability to operate in aisles as narrow as 5ft 6" enables you to reduce your aisle width, and thus add more racking to increase your storage capacity.

- ✔ Excellent Visibility & Ergonomics
- ✔ Increased Storage
- ✔ Lift capacities from 3,300 to 6,600 lbs.
- ✔ Lift heights up to 49ft

[LEARN MORE](#)

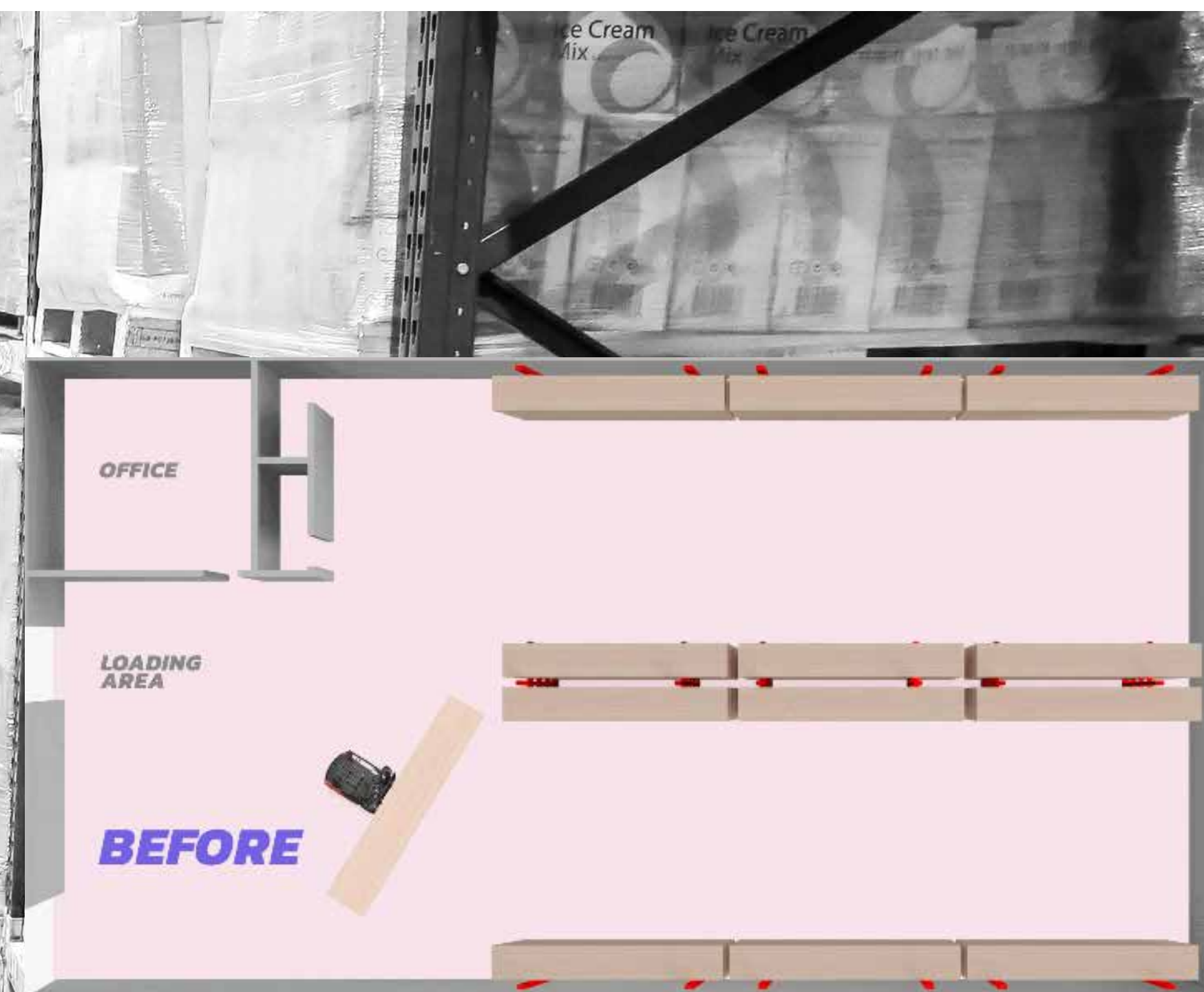
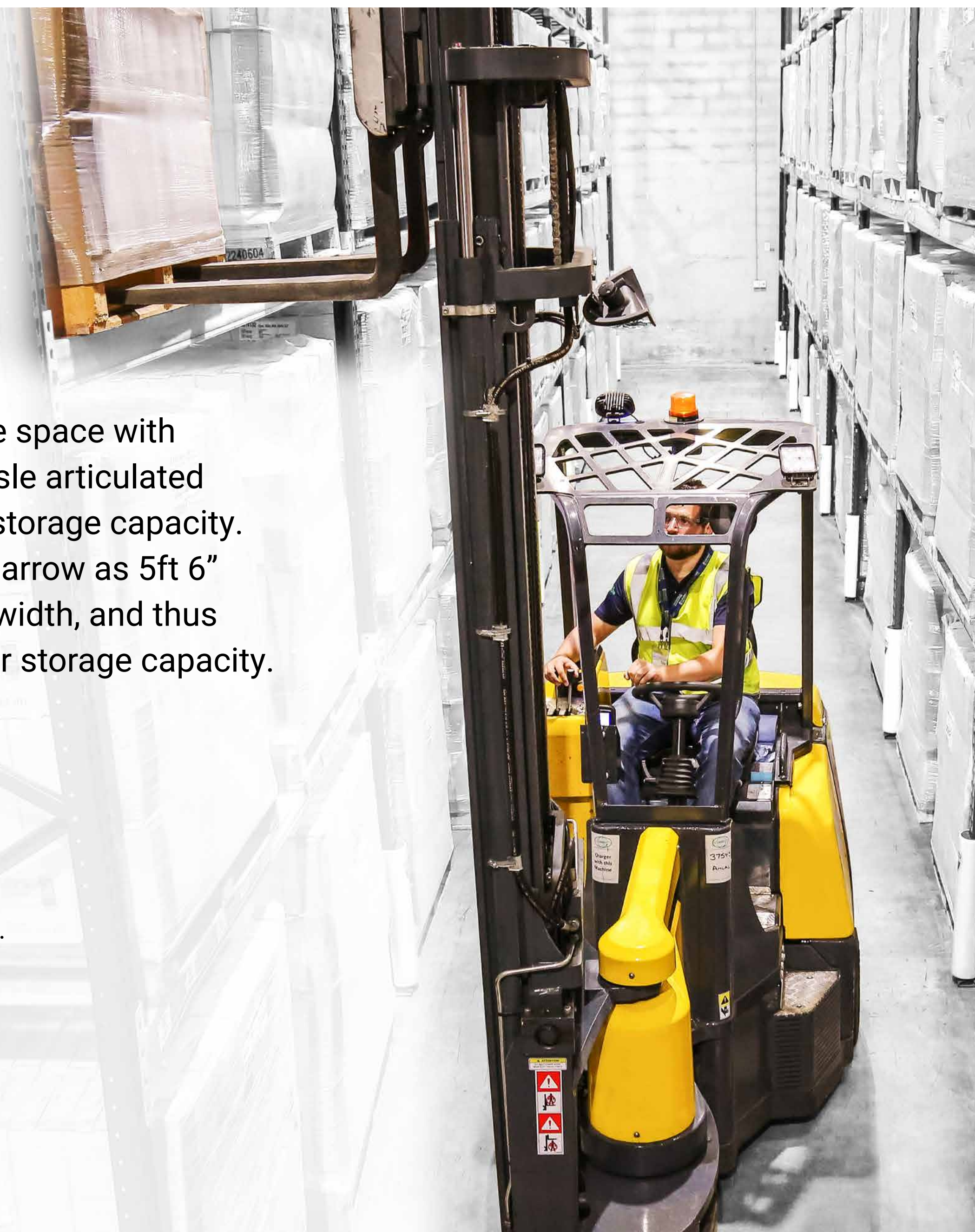

## Combilift Warehouse Optimisation

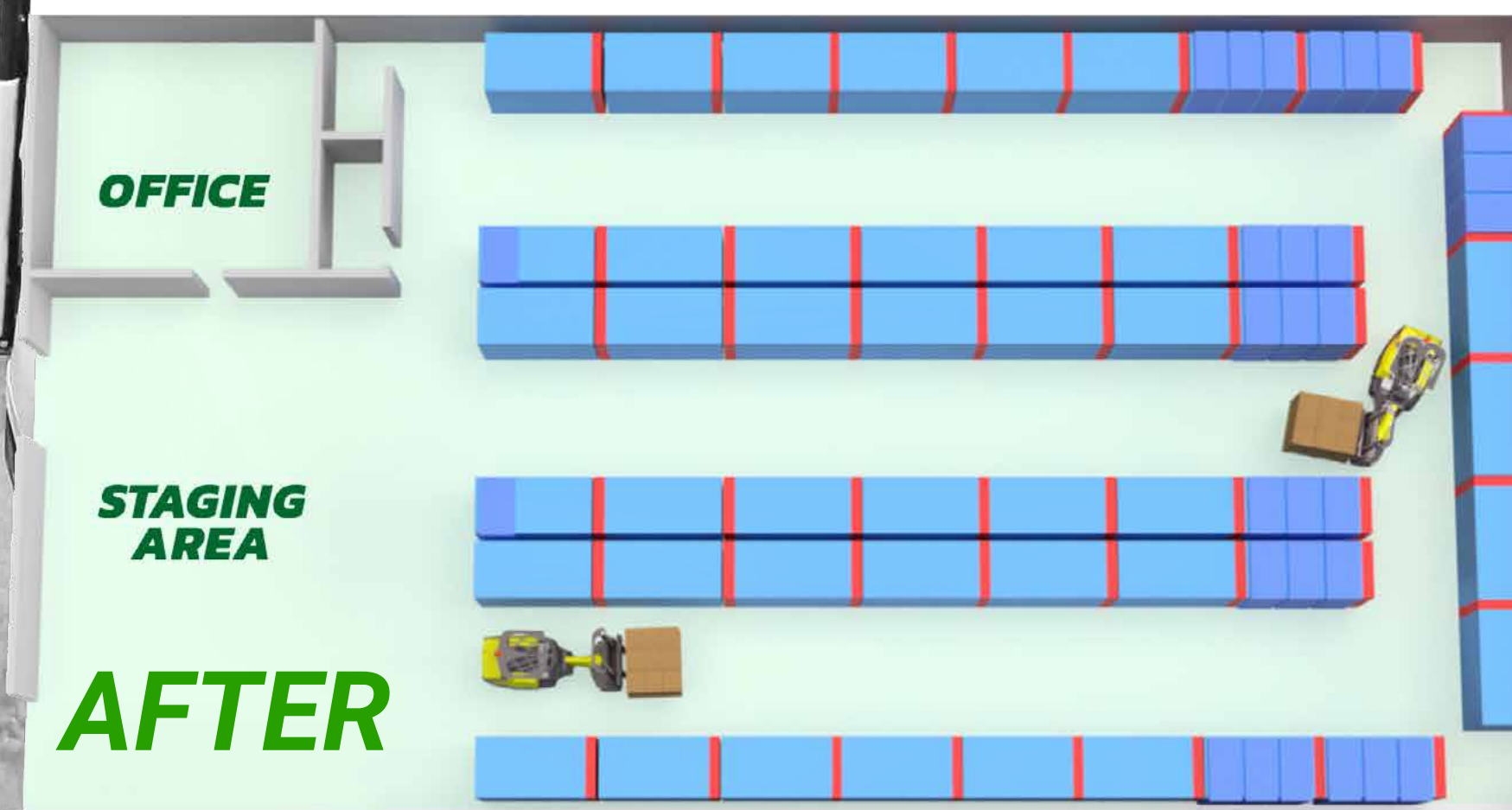

## A Narrow Aisle



# Bendi®

## Bendi Electric Narrow Aisle

- Lift capacities from 3,000 to 5,500 lbs.
- Operate in aisles as narrow as 72"
- Three-stage tilting masts and have lift heights up to 41'
- Four-stage masts are also available on all 4-wheel models for lift heights up to 26'



# DREXEL®

## Landoll Drexel SwingMast®

- Lift Capacities from 3,000 to 12,000 lbs.
- High Visibility Mast (3 or 4 Stage)
- 90° Pivoting and Shifting Mast
- Lift heights up to 31'
- Operate in aisles as narrow as 4-1/2 feet



**A** Aisle Chart

# MINIMUM CLEAR AISLE WHEN HANDLING 48" L x 40" W PALLET

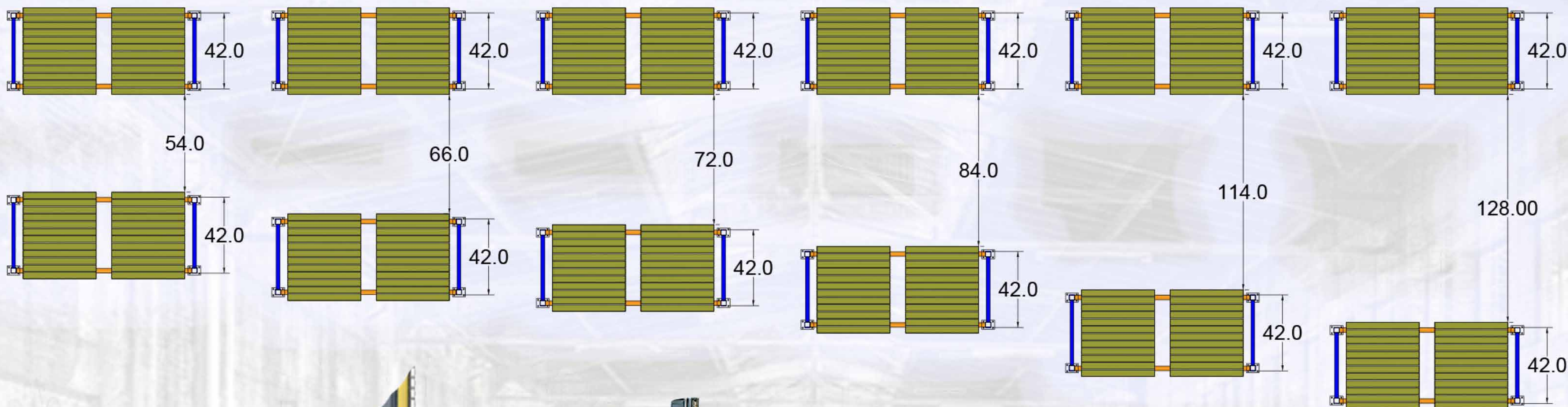

SWING MAST



STACKER CRANE



TURRET



ARTICULATING



REACH



COUNTER BALANCE

## A Lift Truck Attachments

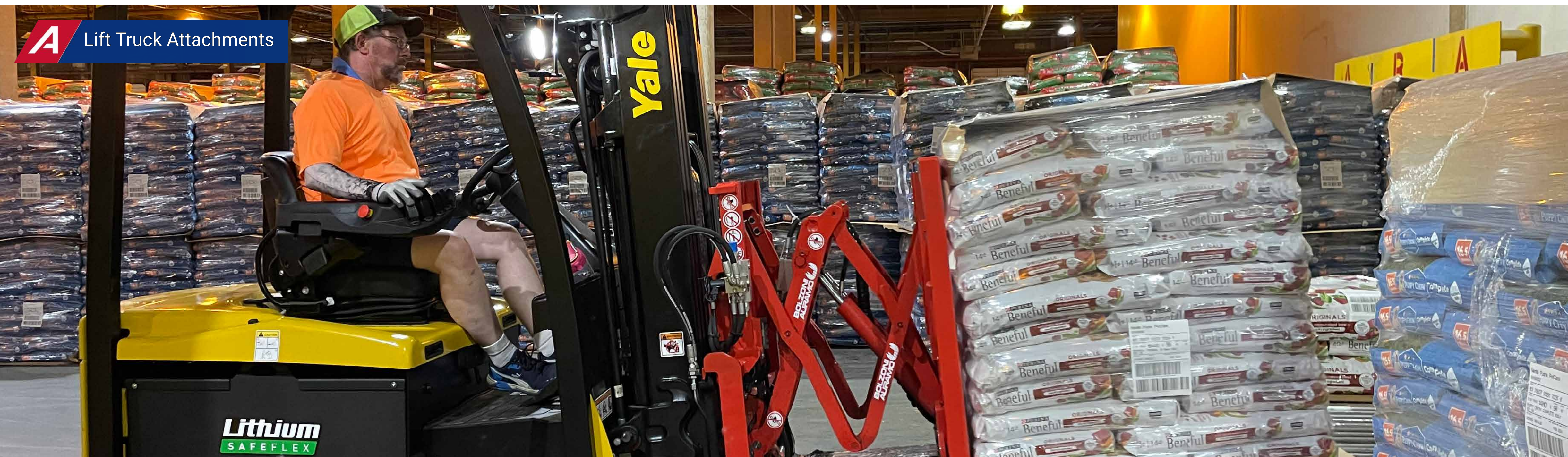

The BOLZONI AURAMO Group offers a wide range of products for the materials handling industry. They specialize in forklift attachments including side-shifters, fork positioners, paper roll clamps, rug poles, and bale clamps.



[LEARN MORE](#)

## **A** Operator Assist System



# Powerful Tool For Operator Awareness

Yale Reliant proactively adjusts lift truck performance based on real-time conditions, dynamically adapting speed and fork control to maintain the combined stability of the lift truck and load. Yale Reliant continuously monitors the combined center of gravity of the lift truck and load it carries to apply carefully measured performance adjustments to avoid abrupt shifts or jerks that can upset stability, while keeping the operator in control of the lift truck.



### Proximity detection

Tracks proximity to other equipment, pedestrians and beacons through local or real-time location technologies, helping inform performance controls.



### Real-time location sensing

Monitors where equipment is and sets exclusion zones to limit speed or restrict trucks from designated areas altogether.



### Object detection

Detects objects in the path of travel through LiDAR technology; including those not connected to proximity tags, helping inform performance controls.

## A Telemetry

# Give your warehouse operation 20/20 vision with Yale Vision

Real-time telemetry lift truck data provides a thorough look into your fleet's day-to-day operations so your team can work smarter.

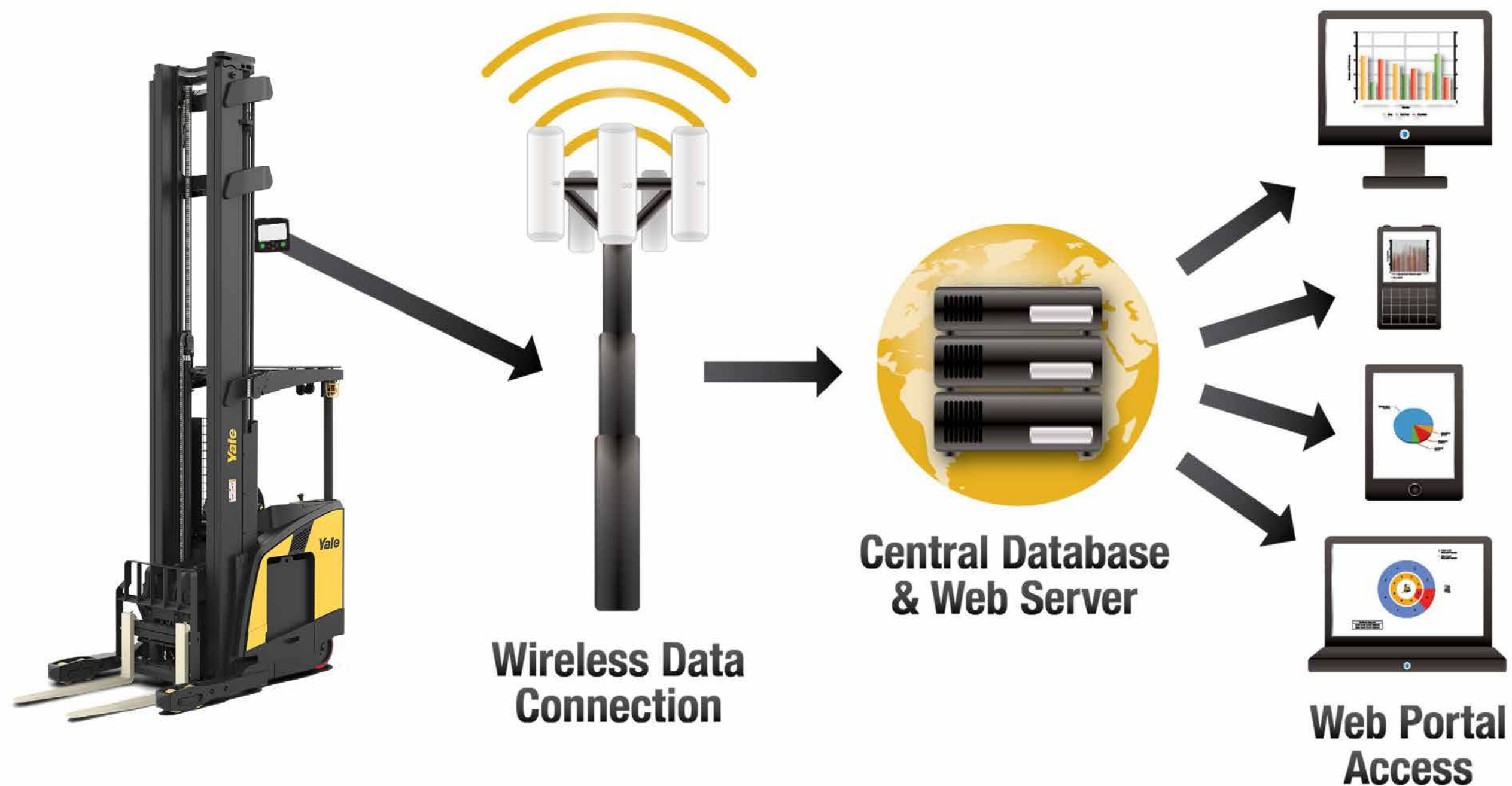
[LEARN MORE](#)

### UTILIZATION PROFICIENCY

Optimize workflow and help boost productivity by analyzing the efficiencies of your operators and equipment.

### EQUIPMENT DIAGNOSTICS

Monitor engine, transmission, hydraulic, and electronic functions to help provide maximum uptime.

### SAFETY TOOLS & EMAIL ALERTS

Proactive monitoring systems will send notifications in real-time to address events in an effective manner with instant follow-up.

### GPS LOCATION

Gain full visibility into the location of your fleet and operators, activity at your site, and where truck impacts are occurring at your facility.

### IMPACT DETECTION

Help improve site safety measures and aid in reducing avoidable damage through accurate impact monitoring and real-time alerts.

### LIVE UTILIZATION

Real-time access to your fleet's status including utilization, availability, charging or maintenance; providing insights to help right-size your fleet.

# ALTA

MOTIVE POWER

POWER TO MOVE MORE

# Upgrade Your Mobile Equipment Batteries

[Lead Acid](#)

[Thin Plate Pure Lead](#)

[Lithium Ion](#)

[Hydrogen Fuel](#)



## **A** Lead Acid Batteries

# Power Your Mobile Equipment with Lead Acid Batteries

Lead acid batteries offer some of the lowest costs of acquisition. Traditional Flat Plate design battery is a tried-and-true technology, appropriate for many applications. In addition, the Tubular design lead acid battery can offer an increased level of performance.

- ✓ 6-8 hour run time
- ✓ 1500+ cycles
- ✓ 99% recyclable
- ✓ A variety of power options
- ✓ Easily integrated



## A Thin Plate Pure Lead Batteries

# Thin Plate Pure Lead Batteries Provide Superior Flexibility

Thin Plate Pure Lead batteries (TPPL) are designed to help reduce the unplanned downtime and unexpected operating costs associated with conventional lead acid batteries.

Optimized for fast and opportunity-charging, TPPL batteries are available in a range of capacities and configurations. They also include intelligent, integrated data management tools that support higher reliability and longer battery life.



Design that powers productivity: 3X more plates and 10% more energy density vs. flooded batteries.



Virtually maintenance-free: no watering, battery cleaning, battery changing, or long equalize charges.

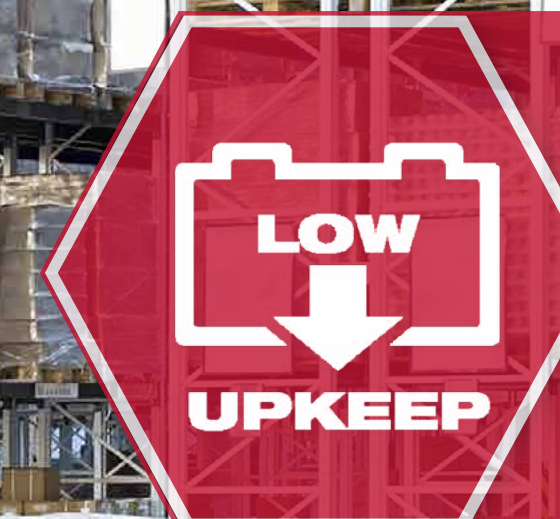

A more flexible workflow: full charge in less than 2 hours; opportunity charge during breaks and whenever convenient.

## **A** Lithium Ion Batteries

# Enhance Your Mobile Equipment with Lithium ion Batteries

Save time, money, and square footage when you upgrade to lithium ion batteries for your mobile equipment. Without the need for a dedicated battery room, you can optimize your facility footprint for more value-added storage and tasks. Increase the sustainability of your mobile equipment and the overall profitability of your facility by upgrading from internal combustion engine or lead acid batteries to lithium ion technology.

### 2X Battery

Lithium ion batteries have on average double the lifespan of lead-acid batteries and can last more than 3,000 charge cycles.

### Improved Performance

Lithium ion batteries have a low depth of discharge (DoD), meaning more usable capacity. Higher nominal voltage for ongoing, persistent performance.

### 65% More Energy Savings

Lithium ion batteries can provide energy savings of up to 65% more than lead acid batteries.

### Less Maintenance

Lithium ion requires less maintenance. No watering is required, no washing, and no equalization charges.



## **A** Hydrogen Fuel Cells

# Hydrogen Fuel Provides Maximum Performance



### Increased Uptime

Hydrogen fuel cells store energy 10x more densely than lithium ion batteries and operate with 100% capacity.



### Refill In < 5 Minutes

Hydrogen mobile equipment refills in 3-5 minutes, runs the entire shift, and has no battery droop, which means a 5% lift in productivity.



### Save Space

Hydrogen fuel cell technology doesn't require dedicated battery rooms or operators like lead acid batteries.





# Extend the Life of Your Batteries & Chargers

With a comprehensive battery and charger service, Alta Motive Power can help ensure you'll have the power you need to increase forklift uptime and overall productivity.

Our dedicated battery and charger service technicians receive extensive training in battery maintenance and can provide recommendations to help you optimize the efficiency of your battery fleet. Our custom-fit solutions can lead to:

- Lower Cost of Ownership
- Optimize Productivity
- Improve Employee Safety

[LEARN MORE](#)



# Improve the Efficiency of Your Racking and Storage

Are you getting the most out of your current storage space? If not, we can help. Whether you're looking for a pallet rack solution to increase storage space, speed up pick times, or maybe even make your space more organized, we have the perfect solution for you.



**Carton Flow**



**Drive-In**



**Cantilever Racks**



**Single Selective**



**Pushback**



**Pick Module**

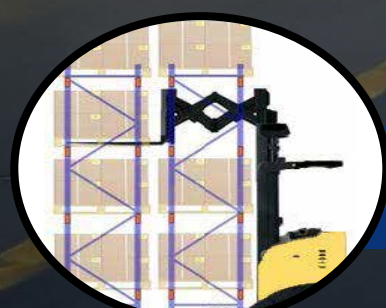

**Double Deep**



**Pallet Flow**



**Industrial Shelving**



**A** Service & Support

# ALTA

**MATERIAL HANDLING**

Moving What Matters Most

## We're Committed to Helping You Maximize Your Uptime

Alta Material Handling offers industry-leading professional support to meet all your mobile equipment needs. You can rely on us for repairs, parts, and an extensive best-in-class network to ensure your mobile equipment needs are met. After all, you're the expert at running your business. Leave the fleet management to us!



### Speedy Diagnostics

Our expert technicians know these machines inside and out, giving you additional peace of mind.



### Parts Available Onsite

We carry a large selection of parts at each of our locations so you don't have to wait for parts.



### Long-term benefits

Keep maintenance costs low and predictable, and extend your equipment lifespan.

[LEARN MORE](#)



**A** Training

# Operator Training Solutions

At Alta Material Handling, our certified professional instructors specialize in delivering top-tier training across various types, makes, and models of industrial equipment. Our training programs are designed to address your material handling challenges, helping your operation to meet demands with a focus on safety and efficiency.

- Operator Training
- Train The Trainer
- Technician Training
- Aerial Lift Safety
- Pedestrian Safety
- Hyster-Yale Product Training

[LEARN MORE](#)



## Moving What Matters Most

Optimize your operations with Alta Material Handling products and services.

Call us to learn how.

800.261.9642

